

Steatite Turbo

Steatite technology water heater with turbo heat-up times



COMFORT

- Turbo heat-up times thanks to 2100W heating element (+ 30% faster)
- Frontal control knob - French design
- Flat chromed thermometer

SAVINGS

- Accurate controls ensured by highly sensitive thermostat
- High-precision bulb thermostat with integrated security
- High-efficiency water inlet
- CFC-free high density insulation for more energy savings

QUALITY - DURABILITY



- Robust and easy to maintain: Steatite heating element adapted to all types of water and removable without draining the tank
- Steatite technology: Ceramic dry heating element - unique patented technology, adapted to highly mineralized, hard or desalinated water
- Magnesium anode for increased protection of the tank
- New generation diamond-quality enamelling
- Pressure relief valve
- Dielectric union
- Specific lip gasket to avoid rust around flange

USER-FRIENDLINESS

- IP 24 - Full compliance with European standards for electrical safety and user protection
- Plug**
- Pilot light



EASY TO INSTALL

 <p>A B C</p> <p>Model available*</p>	<p>ELECTRIC WATER HEATER</p> <p>50 TO 100 L</p> <p>(VERTICAL WALL MOUNTED)</p> <p>Capacity</p>	 <p>Energy saving</p>
 <p>Front control knob</p>	<p>MAGNESIUM ANODE</p> <p>Tank protection</p>	 <p>Heating element type</p>

* Model types : A : Vertical wallmounted / B : Horizontal wall mounted / C: Vertical Floor standing

** Depending on model



STEATITE technology

Ceramic dry heating element + enamelled steel sleeve. Steatite technology: state-of-art ultimate technology for the best long lasting service

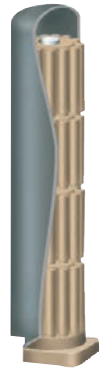

Front control knob

- 1 External thermometer
- 2 Diamond-quality enamel
- 3 Optimised stainless steel outlet pipe
- 4 Magnesium anode
- 5 High power steatite dry heating element
- 6 Inlet diffuser
- 7 Enamelled sleeve
- 8 High-density polyurethane foam 0% CFC
- 9 Frontal control knob
- 10 Dielectric union
- 11 Thermostat

INSTALLATION DIMENSIONS (in mm)

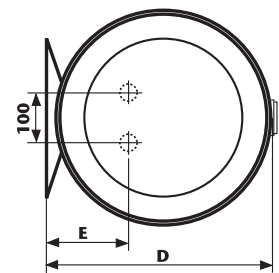
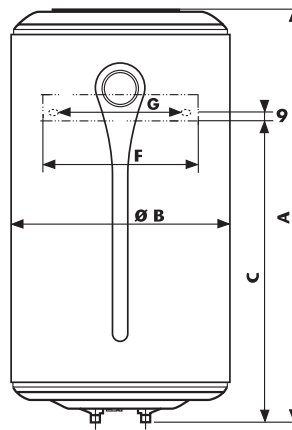

STEATITE Vertical wall mounted

TECHNICAL DATA

CAPACITY (L)	OUTPUT (W)	VOLTAGE (V)	ENERGY CONSUMPTION (KWH/24H AT 65°C)	HEAT-UP TIME AT 60°C (Δt=50°C)
50	2100	230 (220/240)	0.95	1h01
80	2100	230 (220/240)	1.35	2h05
100	2100	230 (220/240)	1.7	2h44

DIMENSIONS

CAPACITY (L)	DIMENSIONS (mm)							FLANGE OPENING (Ø) mm	NET WEIGHT (kg)
	A	B	C	D	E	F	G		
50	585	433	380	451	165	100	240	72	15.1
80	814	433	590	451	165	190	240	72	20.1
100	973	433	740	451	165	280	240	72	24